

Wohneinheit 6

1. Obergeschoss | Haus 1 | 2 Zimmer

ROTEN BLEICHER

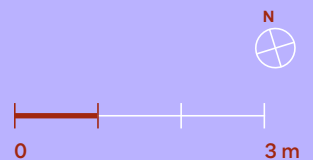
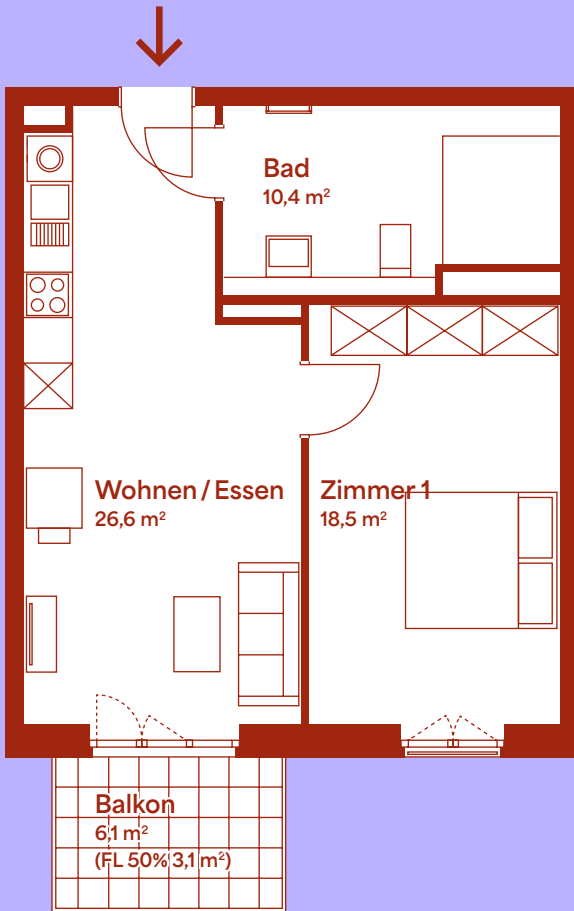

LAGEPLAN

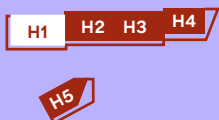

1. OBERGESCHOSS

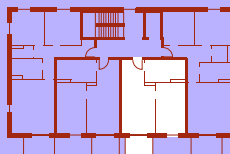

ANSICHT WEST



Zimmer 1	18,5 m ²
Bad	10,4 m ²
Wohnen / Essen	26,6 m ²
Balkon (50%)	3,1 m ²
Grundfläche ca.	58,6 m²